

User Manual

Guide d'utilisation

Benutzerhandbuch

Manuale per l'utente

Manual del usuario

ENGLISH	I
FRANÇAIS	II
DEUTSCH.....	III
ITALIANO	IV
ESPAÑOL	V

User Manual

Disinfecting Device for Ventilation Pipeline and Mask
of Positive Airway Pressure (PAP) Respirator/System



ENGLISH



Thank You!

Thank you for purchasing the SoClean 2 PAP disinfecting device*.

This manual contains a product overview and key setup instructions. Once connected, you'll find that daily disinfecting of your PAP equipment has never been easier. The SoClean patented process destroys 99.9% of PAP germs, bacteria, and other pathogens without the need for water or harsh chemicals. The SoClean 2 allows you to use disinfected PAP equipment daily, with no need to disconnect for disinfecting.

While the SoClean is designed to fit many PAP models, some models require additional parts or steps. If you do not currently have these parts, they can be purchased from SoClean or an authorised reseller.

See SoClean.com for PAP model details.

SoClean is committed to developing innovative and safe ways to improve the health and well-being of PAP users. Please feel free to contact us with any questions you may have at SoClean.com/contact.

*See Indication of Use, Cautions & Specifications.

TABLE OF CONTENTS

INDICATIONS FOR USE, CAUTIONS & SPECIFICATIONS	2
INCLUDED WITH YOUR SOCLEAN	4
SOCLEAN CONTROL PANEL	8
KEY PAP PARTS	10
CONNECTION STEPS	12
SUPPORTED PAP MACHINES & ADAPTERS	15
SET LANGUAGE, CLOCK & DISINFECTING SCHEDULE	17
USING YOUR SOCLEAN	20
CARE & MAINTENANCE OF YOUR SOCLEAN	22
FAQ	22
YOUR HEALTH & OZONE SAFETY	24
CLASSIFICATION, SYMBOLS, FCC NOTICE	25

INDICATIONS FOR USE, CAUTIONS, & SPECIFICATIONS

Indications for Use: The SoClean is a general Positive Airway Pressure (PAP) disinfecting device and is intended to be used in the home. An individual who uses Positive Airway Pressure (PAP) for Obstructive Sleep Apnea (OSA) treatment can use the SoClean to destroy 99.9% of germs and bacteria on PAP equipment or when the user wants the added benefit of thorough PAP system disinfection.

The SoClean attaches to a PAP machine, and runs daily while the mask is inside the Disinfecting Chamber. The SoClean does not need to be disconnected before using the PAP machine.

Contraindications for Use: Do not use the SoClean device if a fragrant essence is used in the PAP water reservoir or if highly fragrant detergents are used to disinfect the PAP equipment. Discontinue use if acne or rash develops along mask contact line.



Read the instruction manual/booklet before operating the equipment.

Use this product only in the manner described in this User Manual. If the equipment is used in a manner not specified by the manufacturer, the safety protection provided by the equipment may be impaired.

Electrical Characteristics:

AC Adapter input: AC 100~240V, 50/60HZ, 0.5A

AC Adapter output: DC 12V, 1.5A Max

Power Consumption: 18W Max

Environmental Characteristics:

Operating: 10°C to 38°C (50°F to 100°F),
15% to 70% humidity

Storage and Transport Conditions:

-20°C to +55°C (-4°F to 131°F),
15% to 70% humidity

Ozone Concentration:

10 ppm @ 5 min when measured 1 cm from the ozone generator output tubing interface on the SoClean device, assuming the starting ozone concentration is < 0.3 ppm prior to turning the SoClean device on.













Physical Characteristics:

Dimensions: 7.875" x 7.25" x 8.875"

Weight: 5.6lbs

Cord Length: 4' 8"

DISCLAIMER: SoClean does not represent through the use of the term disinfect, disinfectant or disinfection herein, or in other documentation, a kill rate of more than 99.9% of bacteria and germs in a PAP.

-  **WARNING:** Ensure the proper Clock time and Cycle Start time are set before using your PAP machine. Pay particular attention to the AM/PM setting if using 12-hr mode. Failure to do so may result in the SoClean device operating at an unexpected time.
-  **WARNING:** In the event of loss of power to your home or the SoClean device, ensure the proper Clock time and Cycle Start time are set before using your PAP machine. Failure to do so may result in the SoClean device operating at an unexpected time.
-  **WARNING:** Do not physically alter the Hose Detect Switch on your SoClean device. Inspect the Hose Detect Switch regularly for damage or inability to move up/down. Failure of the Hose Detect Switch on your SoClean device may result in the SoClean operating at an unexpected time.
-  **WARNING:** Keep away from water sources including rain, bathtubs, sinks, and pools. To clean, wipe with a damp cloth. Do not submerge the SoClean device in liquid or use chemical cleaners.
-  **WARNING:** Keep away from children. Do not inhale from tube or place any living thing inside the Disinfecting Chamber during use.
-  **WARNING:** Do not use in explosive air environments, near gas vapors, or other flammables, etc. Do not place any flammable or ignitable items on top of the SoClean device.
-  **WARNING:** Keep the SoClean Lid closed until the green status light illuminates (approximately 2 hours after completion of disinfection cycle).
-  **WARNING:** Do not dismantle the SoClean device.
-  **WARNING:** The SoClean device should be used according to the procedures described in this manual.
-  **WARNING:** Ozone is a gaseous disinfectant that naturally breaks down after it is generated. The SoClean device is designed to safely contain ozone within the system and has a catalyst Cartridge Filter inside the Disinfecting Chamber to convert ozone back to oxygen. In rare instances those with respiratory sensitivities could experience irritation. Should this occur, please discontinue use and contact SoClean.
-  **WARNING:** Do not place Neutralizing Pre-Wash in the PAP reservoir. Neutralizing Pre-Wash is for disinfecting your PAP equipment only
-  **WARNING:** Please be sure the black Injection Hose from the back of the SoClean is connected to your PAP before operating your SoClean device.

INCLUDED WITH YOUR SOCLEAN

Number	Part Name	SKU	Description
1	Removable Hose Slot Plug	PN1214	This allows you to set up the SoClean device on either the right or left side of your PAP machine. Place this in the hose slot that you don't use.
2	Disinfecting Chamber	N/A	Place your mask in here when you wake up. Close the lid to ensure that the daily disinfecting cycle runs.
3	Lid Gasket	PN1215	Ensures tight seal around the Disinfecting Chamber when the SoClean lid is closed. Do not close the lid without this part in place.
4	SoClean Lid	N/A	Close the lid after you place your mask to ensure that the automated disinfect cycle occurs.
5	Cartridge Filter	PN1207	You can repurchase it along with the Check Valve as part of the Cartridge Filter Kit. This Cartridge Filter converts ozone back into normal oxygen. Remove outer plastic wrapping and blue tape.
6	Neutralizing Pre-Wash (not available in all countries)	PN1101	The Neutralizing Pre-Wash removes any material or odour that could react with ozone. Wash your PAP equipment before connecting the SoClean device, or when you receive a new mask, hose or reservoir.
7	Hose Detect Switch	N/A	<p>The Hose Detect Switch detects when the SoClean device is configured for operation by detecting the presence of the hose in the hose slot when the lid is closed. When there is no hose installed in the hose slot the SoClean device is designed to not run a disinfecting cycle. Hose Detect Switch operation can be inspected by gently pushing down and releasing the gray plastic switch and hearing an audible click. The switch should move freely down and up when gently pressed.</p> <p>Note: Do not remove gasket from Hose Detect Switch slot.</p>

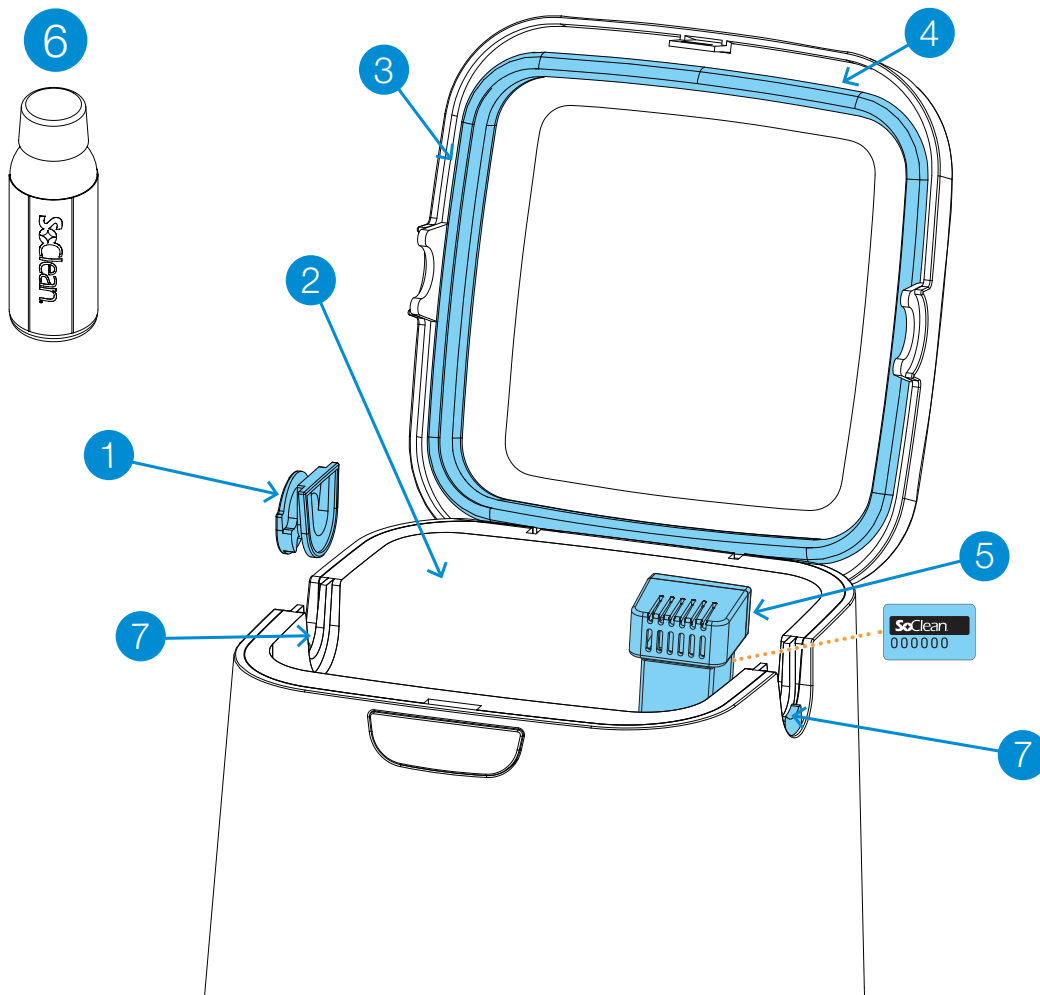

INCLUDED WITH YOUR SOCLEAN

Number	Part Name	SKU	Description
8	Control Panel	N/A	Buttons, display, and cycle light indicator for SoClean functions. See page 8 for details.
9	Injection Hose A & B	PN1104.12	The Injection Hose A & B carries ozone from the SoClean device to the PAP machine. See page 14.
10	Check Valve	PN1207	This item comes pre-installed into the Injection Hose. You can repurchase it along with the Cartridge Filter as part of the Cartridge Filter Kit. It is a one-way Check Valve that prevents water in your humidifier reservoir from backing up into entering your SoClean device. If you can see water in this clear tube, replace the Check Valve assembly immediately.
11	Injection Fitting	PN1106 (with humidifier reservoir) PN1116 (without humidifier reservoir)	Connects the Injection Hose A & B to your PAP machine. See page 13.
12	AC Adapter	PN1209	Supplies power to your SoClean device. See page 14.

Replacement Parts

You will replace some SoClean parts regularly due to normal wear and usage. A message appears on your SoClean after a certain amount of use (typically around six months) as a reminder to replace the Cartridge Filter and Check Valve. These two parts are ordered as a set called the Cartridge Filter Kit (PN1207).

The Neutralizing Pre-Wash is also available for purchase if you run out. You can also use another fragrance-free, dye-free dish soap.

To reorder supplies, contact your authorised reseller or visit **SoClean.com** and search for the desired part.



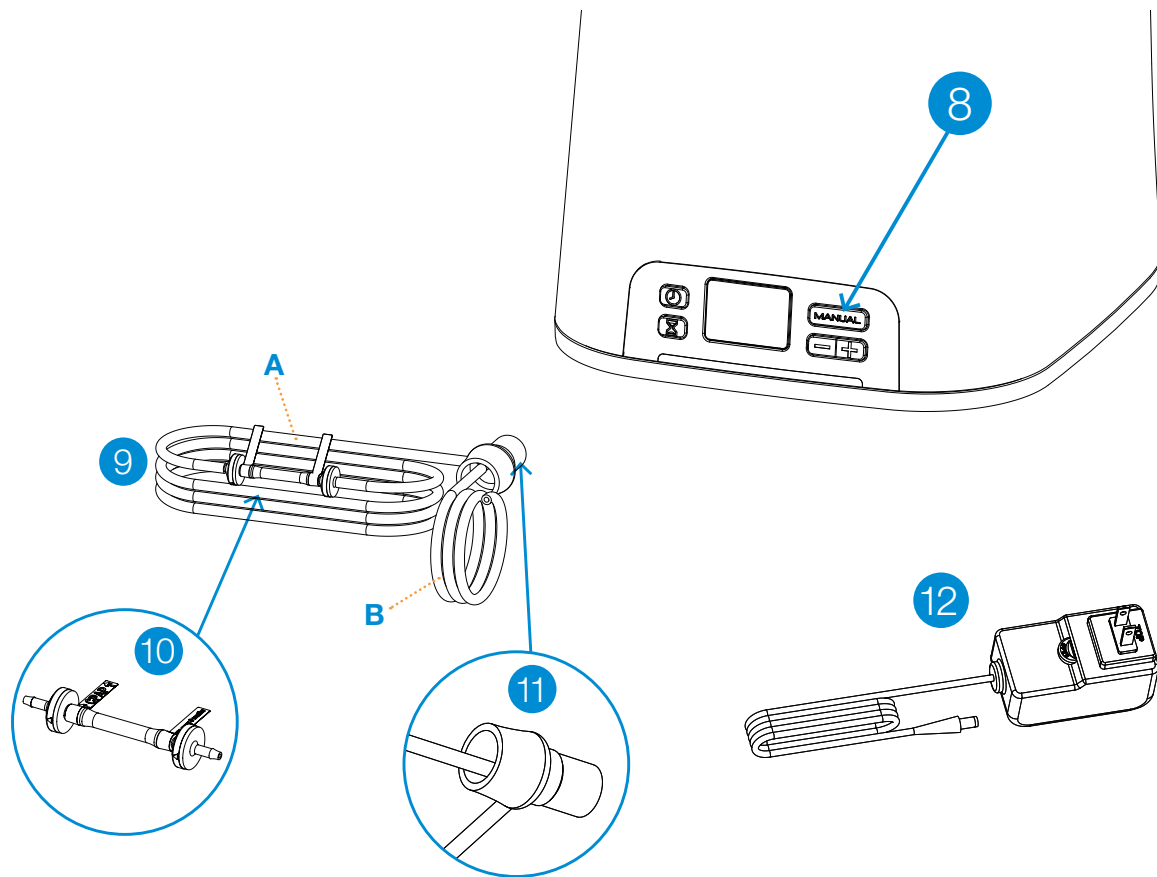

WARNING: Please purchase your Cartridge Filter Kits from SoClean® only. Authentic Cartridge Filter Kits can be purchased from SoClean via multiple online marketplaces, such as Amazon® and eBay® in addition to SoClean.com, however please confirm that the seller of your Cartridge Filter Kit is SoClean, and not any other seller, to ensure the authenticity of your Cartridge Filter Kit. SoClean has discovered counterfeit Cartridge Filter Kits being sold, particularly on Amazon® and eBay®, with check valves and filters, that leak and can cause damage to your SoClean machine or to your property due to water leakage from the counterfeit check valves. Please contact SoClean immediately if you have had any issues with your Cartridge Filter Kit. Amazon® is a registered trademark owned by Amazon Technologies, Inc. eBay® is a registered trademark owned by eBay, Inc. SoClean® is a registered trademark owned by SoClean, Inc.



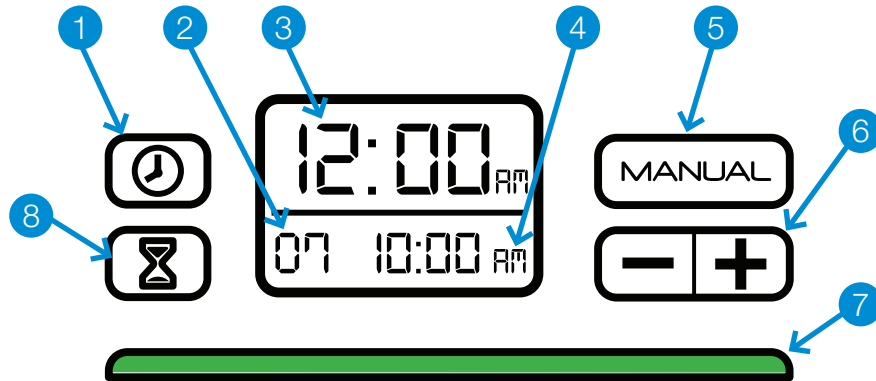

SOCLEAN CONTROL PANEL



⚠ WARNING: In the event of loss of power to your home or the SoClean device, ensure the proper Clock time and Cycle Start time are set before using your PAP machine. Failure to do so may result in the SoClean device operating at an unexpected time.

Number	Button(s)/Display	Description
1		Sets the clock. See page 17.
2	Disinfecting Cycle Length	The length, in minutes, of the disinfecting cycle. See page 18 to set this. Default disinfecting cycle length set to 7 minutes.
3	Current Time	The current time. See page 17 to set. Default time set to 12:00am.
4	Daily Disinfecting Start Time	The time when the daily disinfecting cycle starts. See page 18 to set the schedule. Default disinfecting cycle start time set to 10:00am.
5		Starts a disinfecting cycle immediately. The scheduled disinfecting will still occur. See page 19.
6		Decreases (-) or increases (+) time.

Number	Button(s)/Display	Description
7	Status Light	<p>The light below the display indicates the disinfecting cycle status. See pages 17, 18 and 19 for instructions on scheduling and manual operation. A green light indicates that disinfecting is complete, and you can remove your PAP mask from the SoClean Disinfecting Chamber and use your PAP machine.</p> <p>RED – The SoClean is operating and generating ozone.</p> <p>YELLOW – The 2-hour disinfecting cycle is still active. The ozone is working and dissipating.</p> <p>GREEN – Disinfection cycle is complete. You can use your PAP machine any time. The light turns off when you open the lid.</p>
8		Sets daily disinfecting start time. See page 18.
	 and 	Changes clock to 24-hour or 12-hour format. See page 17.

Messages

The SoClean display panel shows messages that can require action. This list shows the messages and how to correct them:

Message	What to Do
Hose not present. Cycle will not run.	Ensure that the PAP hose is seated securely in the hose slot. Check that the Removable Hose Slot Plug is seated correctly on the other side. See page 20.
Order Filter Kit.	Your Cartridge Filter has reached the end of its life based on your use. See page 23.
Disinfection in process. Do not open the lid!	Ozone present. The SoClean device is performing disinfection. This takes approximately 2 hours. The green cycle indicator light means that disinfection is complete. You can now open the lid, take out your mask, and use your PAP machine.

KEY PAP PARTS

The SoClean device is designed to connect permanently to your PAP machine and allow operation of either product.

The SoClean device connects to most PAP machines using the standard included parts. This section describes key parts of your PAP machine in the connection procedure. The figure on the next page shows a generic representation of these key parts.

Some PAP machines have features that require additional steps or parts. Adapters required for SoClean to function with your PAP contain appropriate instructions. See page 15 for a list of available adapters for specific PAP machines.

See **SoClean.com** for additional instructions for specific PAP machines.

These are typical parts of a PAP machine that are referenced in the SoClean connection procedures. These are only representations—your actual PAP machine can look different than these drawings. Review the documentation that came with your PAP machine for a better idea of what these parts look like.

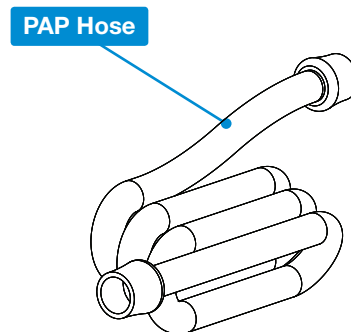
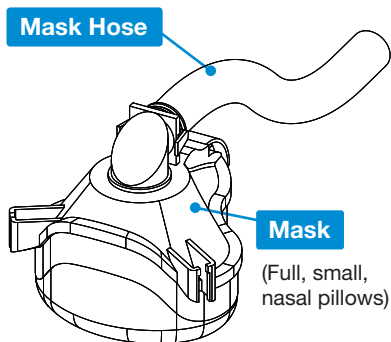
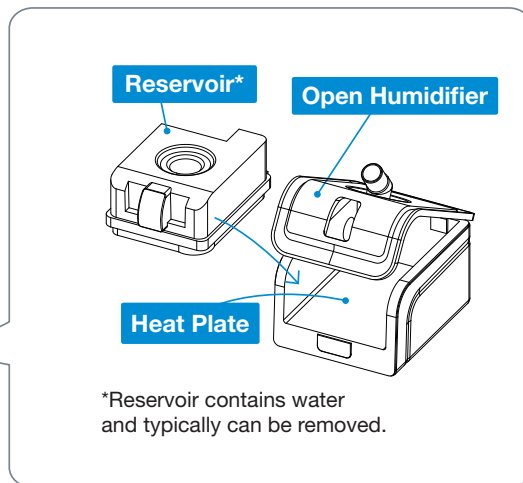
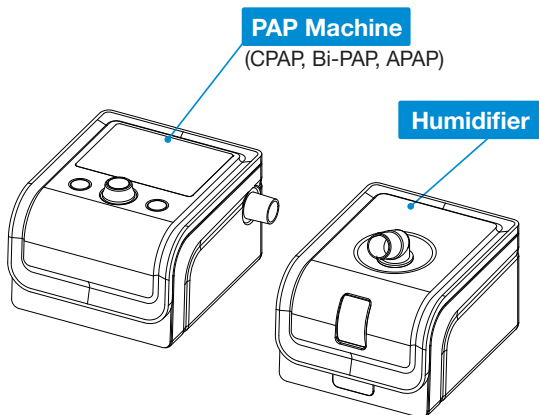

CONNECTION STEPS

After following these steps, your SoClean device will disinfect your PAP machine daily without disconnecting. Before you disconnect your PAP machine to wash the parts, look at where the PAP hose is connected. You will reconnect the SoClean Injection Fitting to the same location.

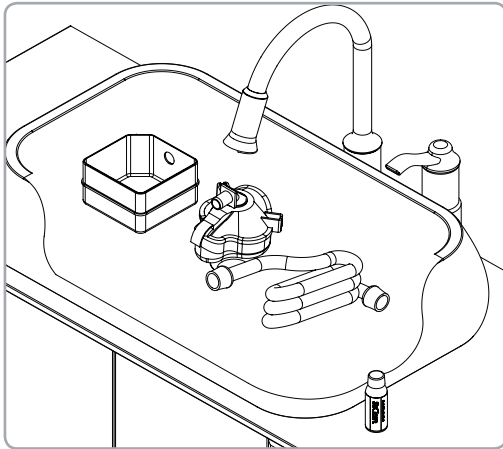

Figure 1. Disassemble and Wash PAP Equipment

1. Pre-wash PAP Equipment

Disconnect your PAP mask, hose, and reservoir from the PAP machine.

Use two capfuls of the included Neutralizing Pre-Wash (may not be included in some countries) (fragrance-free dish soap can be used) with a gallon (4L) of water to wash your PAP equipment (mask, hose, and reservoir) according to manufacturer instructions (figure 1).

Rinse thoroughly with clean water.

Reinsert the reservoir (if used) into the PAP machine. Do not reattach the hose or mask yet.

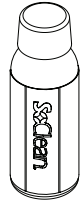

WARNING: Do not place Neutralizing Pre-Wash in the PAP reservoir. Neutralizing Pre-Wash is for cleaning your PAP equipment only.

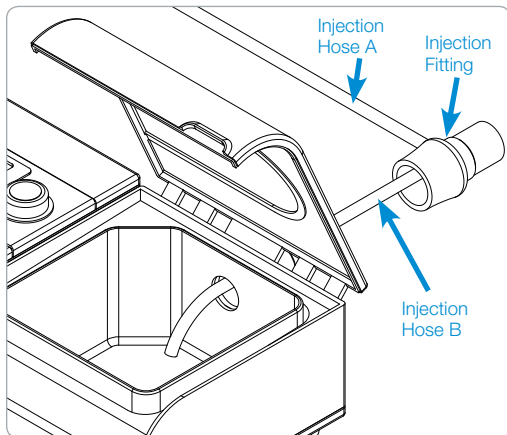

Figure 2. Connect the Injection Fitting

2. Using an Adapter

If your PAP machine requires an adapter, see adapter instructions for set-up and proceed to Step 5.

3. Connect the Injection Fitting

The Injection Fitting connects the SoClean to your PAP machine. Once installed, you do not need to disconnect the Injection Fitting to use your PAP. The SoClean is intended to stay connected to your PAP continuously.

Note: Your PAP reservoir model may require additional configuration procedures or an adapter. If you have difficulty with the steps in this guide, visit:

SoClean.com for information on various models.

With humidifier:

1. Position the Injection Fitting onto the port of your humidifier (where your PAP hose was connected), allowing the smaller Injection Hose B to enter into the reservoir (figure 2). The end of the tubing should be positioned over the heat plate.
2. If necessary, carefully trim the Injection Hose B in increments until it is the correct length, and over the heat plate.

Note: The SoClean will disinfect your equipment with or without water in the reservoir. The SoClean will purify the water only if the end of Injection Hose is below the water level.

For additional help to connect to your specific machine, please visit our support pages at:

SoClean.com

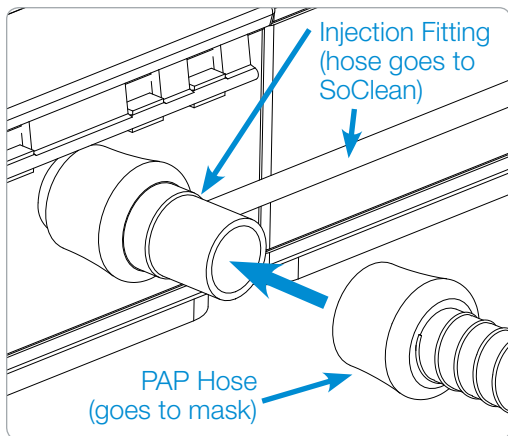

Figure 3. Connect PAP Hose to Injection Fitting

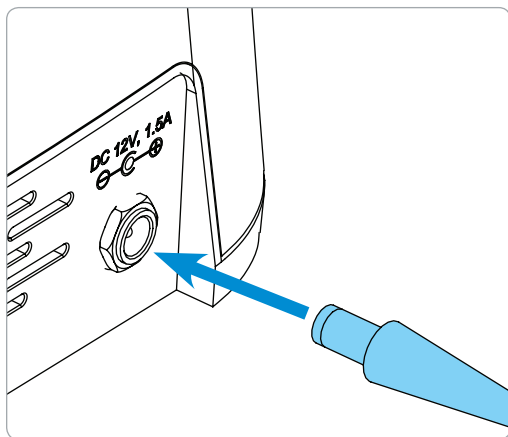

Figure 4. Connect AC Power

Without humidifier:

1. Pull off the small Injection Hose B from the inside of the Injection Fitting.
2. Attach the Injection Fitting directly to your PAP machine.
3. Reconnect your PAP hose to the end of the Injection Fitting.



WARNING: Please be sure the black Injection Hose from the back of the SoClean is connected to your PAP before operating your SoClean device.

Note: If you are having difficulty connecting to your PAP, an additional part may be necessary. Contact **SoClean.com**.

4. Connect the PAP Hose

Regardless of your humidifier, you can now connect your PAP hose to the end of the Injection Fitting, which is connected to your PAP machine (figure 3).

5. Connect Power

On the back of the SoClean device, plug the AC Adapter in the connector marked DC 12V, 1.5A.

The AC Adapter should be plugged into a wall outlet that is easy to access and observe. (Figure 4)



WARNING: In the event of loss of power to your home or the SoClean device, ensure the proper Clock time and Cycle Start time are set before using your PAP machine. Failure to do so may result in the SoClean device operating at an unexpected time.

6. Reconnect PAP Equipment

You can now reattach the mask to the end of the PAP hose.

SUPPORTED PAP MACHINES & ADAPTERS

The following PAP machines have adapters available from SoClean.
To order, go to: Your authorised reseller or **SoClean.com**.

Manufacturer	Model	PN
Fisher & Paykel	Icon	PNA1100i
	SleepStyle 600 Series	PNA110i-600
Philips Respironics	DreamStation	PNA1410
	PR System One REMstar 60 Series	PNA1410
	PR Systems One REMstar	PNA1410
	DreamStation Go	PNA1214
ResMed	S9	PNA1109
	AirSense10	PNA1210
	AirMini	PNA1214
Transcend & Z1	Works with all models	PNA1213

*Note: This list and adapter availability is based on October 2018. If there is any PAP equipment that needs an adapter and it is not listed here please visit **SoClean.com** or contact your authorised reseller.

SoClean, is an independent company not affiliated with Aeiomed, Apex Medical, Carefusion, Fisher & Paykel, Philips Respironics, PMI Probasic, Puritan Bennett, RESmart, ResMed, or Transcend. Names and associated trademarks are solely owned by the respective companies and manufacturers. Depictions of brand logos on our website are for informational and educational purposes only and are used for customer equipment recognition. We are not affiliated or endorsed by any PAP equipment manufacturer.

SET LANGUAGE

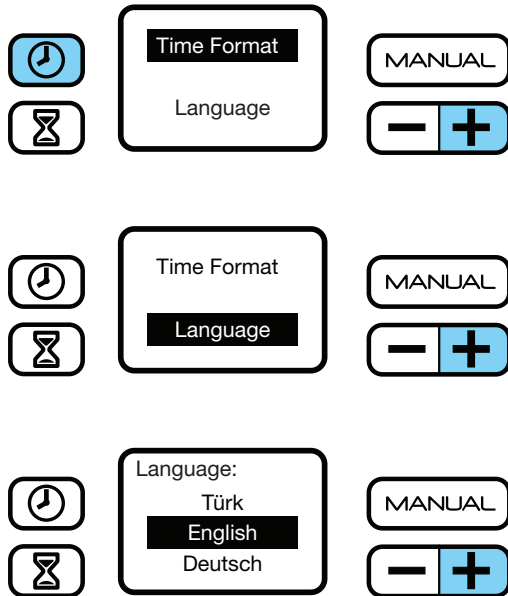

Language

To choose correct language:

1. Press the and buttons simultaneously.
2. Choose 'Language' by using the button.
3. With 'Language' selected, press the button
4. Scroll through language options by using the button.
5. Press the button to select language of choice.
6. Press the button to save.

SET CLOCK & DISINFECTING SCHEDULE

WARNING: Ensure the proper Clock time and Cycle Start time are set before using your PAP machine. Pay particular attention to the AM/PM setting if using 12-hr mode. Failure to do so may result in the SoClean device operating at an unexpected time.

WARNING: In the event of loss of power to your home or the SoClean device, ensure the proper Clock time and Cycle Start time are set before using your PAP machine. Failure to do so may result in the SoClean device operating at an unexpected time.

If you unplug the SoClean or experience a power loss, you will need to reset the current time only. The disinfecting settings will remain saved. For safe use, operate your SoClean only as instructed in this guide.

Your SoClean timer allows you to completely automate your daily disinfecting after connecting to your PAP. The SoClean comes preset to start a 7 minute disinfecting cycle at 10:00am daily. However, **you must set the clock to your current time**. The following procedures describe how to set the clock, schedule the daily disinfecting and start a disinfecting cycle immediately.

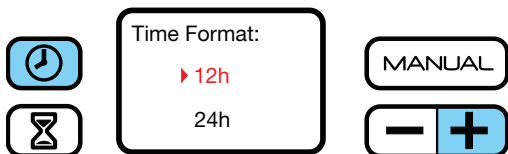

Set the Clock

1. Press the button.
2. Change the time by pushing either the or button until your current time is reached. By holding down the button the time moves faster. Press the button once more to store your time and return to the home screen.

24-Hour Clock

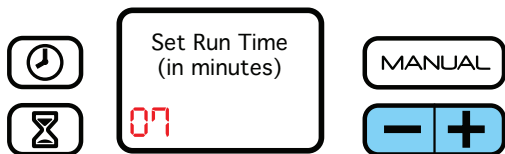
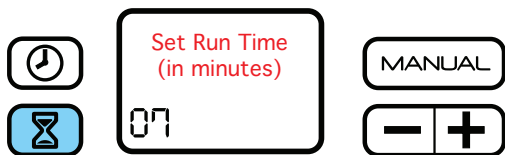

To display in 24-hour format (military time):

1. Press the and buttons simultaneously.
2. With 'Time Format' selected, press the button.
3. Choose either the 12 or 24-hour format by using the button.
4. Press the button.
5. Press the button to save.







Set Cycle Length/ Schedule the Daily Disinfecting

These two processes follow each other in this setup.

1. Press the  button.
2. Press the  or  button to decrease or increase the number of minutes of your cycle time.

Note: A run time of 5 to 12 minutes should disinfect your PAP equipment. If you are in a climate with high humidity and temperature, a longer disinfecting cycle might be necessary.

4. Press the  button again to save your cycle length and schedule the cycle start time. To skip the start time setup, press the  button again when you reach this step.

5. Press the  or  buttons to reach the desired start time. Press the  button again to save and return to the home screen.

Note: Schedule a start time at least two hours before you need to use the PAP machine. The entire disinfecting cycle requires two hours plus the disinfection time to complete. A green indicator light means that the cycle completed.



Manual Mode

To disinfect your equipment immediately. The automated daily disinfecting will still occur if your PAP equipment is stored in the Disinfecting Chamber.

Ensure that your PAP equipment is in place and the SoClean lid is closed.

1. Press the **MANUAL** button to begin the disinfecting cycle.

The disinfecting cycle starts immediately and runs for the set cycle time.

As with your normal disinfecting procedure, wait for the green light before removing your mask. It's not necessary to remove your mask immediately after observing the green light.

USING YOUR SOCLEAN

After setup, using your SoClean device is extremely easy. After following the connection procedure on page 12, your SoClean device disinfects your PAP equipment daily.

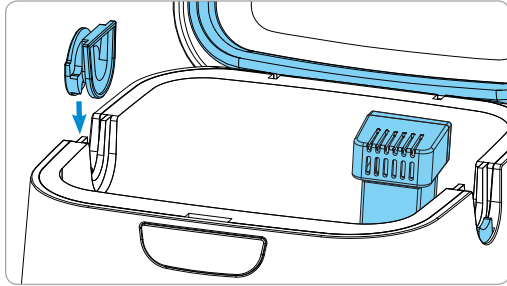

Figure 6. Install Removable Hose Slot Plug

WARNING: Do not physically alter the Hose Detect Switch on your SoClean device. Inspect the Hose Detect Switch regularly for damage or inability to move up/down. Failure of the Hose Detect Switch on your SoClean device may result in the SoClean operating at an unexpected time.

1. Open the lid.
2. Install the Removable Hose Slot Plug into one open slot (figure 6).

Orient the Removable Hose Slot Plug as shown in figure 6. The round face of the Removable Hose Slot Plug is outside of the SoClean device.

Note: Your mask and PAP hose can insert from either side of the SoClean device. To change sides, remove the Removable Hose Slot Plug by lifting it straight out, and insert it into the slot on the opposite side.

3. Remove the plastic wrap from the Cartridge Filter and fully seat it in the Cartridge Filter Slot within the Disinfecting Chamber.

4. Insert your mask into the Disinfecting Chamber allowing its attached PAP hose to rest in the open hose slot, opposite the Removable Hose Slot Plug (figure 7).

5. Close the lid with the PAP hose placed in the open slot (figure 8). The SoClean will now automatically operate according to its preset time and duration.

Note: The SoClean won't operate without the mask and hose present in the closed Disinfecting Chamber. Additionally, the SoClean will not operate if the Removable Hose Slot Plug is missing or improperly seated.

WARNING: Keep the SoClean Lid closed until green status light illuminates (approximately 2 hours after completion of disinfection cycle). It is necessary to let the mask remain in the closed Disinfecting Chamber for at least 2 hours to ensure that the ozone performs its disinfection function and dissipates appropriately. After that period, the status light shines green and the mask is ready to be removed from the Disinfecting Chamber. Ozone quickly dissipates in normal atmosphere. If you accidentally interrupt the disinfection cycle and release ozone by opening the Disinfection Chamber before the end of the disinfection cycle, simply step away from the SoClean device to avoid unintended exposure.

Tip: The SoClean will disinfect your equipment with or without water in the reservoir. The SoClean will purify the water only if the Injection Hose B end is below the water level.

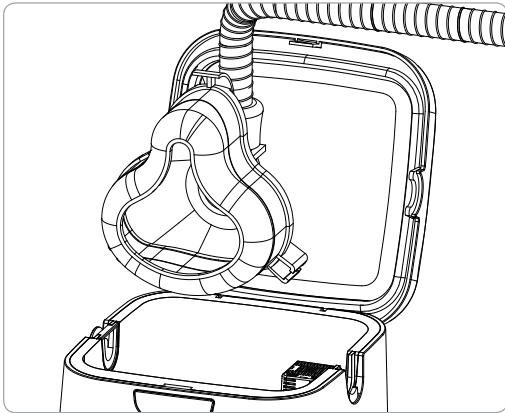

Figure 7. Put PAP mask into Disinfecting Chamber

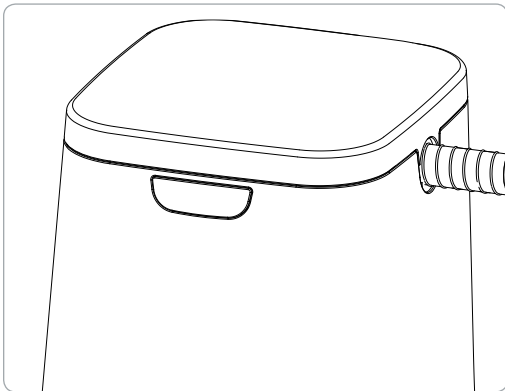

Figure 8. Closed lid with PAP mask inside

6. Once the cycle has completed (status light will be green), open the lid and remove the PAP mask. Remove the Removable Slot Plug and place inside the SoClean Disinfecting Chamber.

Tip: Placing the Removable Slot Plug into the Disinfecting Chamber helps prevent accidental loss of the Removable Slot Plug.



WARNING: Ozone is a gaseous disinfectant that naturally breaks down after it is generated. The SoClean is designed to safely contain ozone within the system and has a catalyst Cartridge Filter inside the Disinfecting Chamber to convert ozone back to oxygen. In rare instances those with respiratory sensitivities could experience irritation. Should this occur, please discontinue use and contact SoClean.com.

CARE & MAINTENANCE FOR YOUR SOCLEAN DEVICE

Wipe down the SoClean device with a damp cloth. The Neutralizing Pre-Wash (not available in all countries) should only be used with your PAP equipment.

Do not submerge or fill the SoClean device with water!

The SoClean Check Valve and Cartridge Filter should be replaced every 6 months. A reminder message on the display will appear after approximately six months, depending on usage.

To reorder supplies (Cartridge Filter, Check Valve, or Neutralizing Pre-Wash), contact your authorised reseller or visit **SoClean.com** and search for the desired part.

If the SoClean has been dropped or visibly damaged or if cracks in the tubing or enclosure are noticed, stop using the SoClean and contact Customer Service.



Please purchase your Cartridge Filter Kits from SoClean® only. Authentic Cartridge Filter Kits can be purchased from SoClean via multiple online marketplaces, such as Amazon® and eBay® in addition to SoClean.com, however please confirm that the seller of your Cartridge Filter Kit is SoClean, and not any other seller, to ensure the authenticity of your Cartridge Filter Kit. SoClean has discovered counterfeit Cartridge Filter Kits being sold, particularly on Amazon® and eBay®, with check valves and filters, that leak and can cause damage to your SoClean machine or to your property due to water leakage from the counterfeit check valves. Please contact SoClean immediately if you have had any issues with your Cartridge Filter Kit.

Amazon® is a registered trademark owned by Amazon Technologies, Inc. eBay® is a registered trademark owned by eBay, Inc. SoClean® is a registered trademark owned by SoClean, Inc.

FAQ

1. Will my PAP equipment be wet from the SoClean?

No. The SoClean destroys 99.9% of PAP germs and bacteria with ozone. No fluids or water are used in this process. Residual water in the reservoir will be disinfected, as described on page 20, as long as the Injection Fitting B is submerged in water.

2. Is the SoClean harmful to me or the environment?

No. The SoClean destroys 99.9% of PAP germs and bacteria with ozone. This technology is used on fruit and vegetable produce and drinking water. The SoClean produces ozone in a closed system. The ozone disinfects your equipment and naturally breaks down to regular oxygen completely within two hours. Additionally, the included Cartridge Filter converts ozone back to regular oxygen.

3. How do I know that my SoClean is operating properly?

After the disinfecting cycle has successfully completed, the status indicator light will illuminate green. Your PAP equipment will have a light, clean scent.

4. What if the scent the SoClean leaves is too strong for me?

Wash your equipment with the Neutralizing Pre-Wash (not available in all countries), and not with any scented soap products (described on page 12). These products can react to the oxidizing process and produce undesirable odours. If the odour is still strong, you may try any of these steps: **(1)** Before wearing your mask at bedtime, run your PAP for 20 seconds to allow any residual scent to blow out. **(2)** Schedule the machine to run earlier in the day, allowing any residual scent to dissipate by nighttime. **(3)** Increase the cycle duration time up to 12 minutes for a few days. A strong odour can indicate a high amount of oxidized organics, such as odourized detergent. A longer cycle can remove these organics completely. You can shorten the cycle time again if this helps reduce odour.

5. What if my indicator light is shining red or yellow?

This means that the disinfecting cycle is not yet complete. Wait until the light turns green to remove your PAP equipment from the SoClean Disinfecting Chamber. (See page 9)

6. It has been more than two hours since the SoClean completed a cycle, but the status light is still yellow.

Why? Some types of indoor lighting make it difficult to distinguish the yellow and green lights on the SoClean. Confirm green light is visible before opening your SoClean to ensure a cycle is complete and your PAP equipment is disinfected and ready for use. You can open the lid in this case.

7. What if the indicator light is off after a scheduled disinfecting time? The SoClean is green when a disinfecting cycle completes successfully. If there is no light, the cycle did not start.

Common reasons for this are that the lid was not securely closed, there was no mask in the Disinfecting Chamber at disinfecting time or the Removable Hose Slot Plug is missing or not properly seated (see page 20). If everything looks good, then close the lid and press the  button to test. Any error message will appear on-screen, (see page 9 for error messages).

8. What if I missed my scheduled disinfecting time, but still wish to disinfect my equipment? You can use the Manual function to run a cycle. (See page 19).

9. Why does my display say Order Filter Kit?

This message appears approximately every 6 months, depending upon usage, as a reminder to regularly replace the Cartridge Filter and Check Valve. These parts wear out due to regular use. You can purchase the Cartridge Filter and Check Valve together in a Cartridge Filter Kit (PN1207). To reorder, contact your authorised reseller or visit **SoClean.com**.

10. Are there materials that I should avoid putting into the SoClean? The SoClean device is designed to disinfect only your PAP equipment. Nylon and natural rubber break down when exposed to ozone. PAP manufacturers typically do not use these materials in their reservoirs, hoses, masks or headgear. If you have questions, contact your PAP manufacturer, supplier or SoClean.

11. My mask feels oily, what should I do?

Skin chemistry is unique. Some individuals with an oily skin type should hand-wash the mask occasionally. If you hand-wash your mask, be sure to use the Neutralizing Pre-Wash or a fragrance-free, dye-free dish soap.

12. How often should I wash my PAP equipment?

PAP equipment should be washed regularly using the provided Neutralizing Pre-Wash or a fragrance free, dye-free dish soap.

For further questions or concerns, visit our website:
SoClean.com

For warranty information visit **SoClean.com/warranty**.

YOUR HEALTH & OZONE SAFETY

Precautions for Beneficial Use of the SoClean

- Activated oxygen, the triatomic form of oxygen (O_3), is known as ozone gas.
- Ozone is an effective, invisible disinfectant.
- SoClean uses ozone to disinfect Positive Airway Pressure (PAP) equipment; ozone contacts the PAP equipment only, not the user.
- SoClean is designed to control ozone production sufficient for disinfection of your PAP equipment and limit over-exposure.
- While breathing large amounts of ozone can irritate breathing passages of humans and pets, following the instructions for use ensures SoClean users will not breath large amounts of ozone.
- The smell of ozone is detectable at low concentrations by some people. The scent of ozone has the characteristic of a sweet chlorine-like smell. If a strong ozone odour is detected when the SoClean is operating per the instructions for use, inspect for visible damage, such as cracks in the enclosure or tubing along with tubing connections.
- Persons with chronic or acute respiratory problems such as asthma, bronchitis, colds, flu, and irritated breathing passages (mouth, nose, throat) should consult with their medical doctor about using this product.
- Ozone quickly dissipates in normal atmosphere. If you accidentally interrupt the disinfection cycle and release ozone by opening the Disinfection Chamber before the end of the disinfection cycle, simply step away from the SoClean device to avoid unintended exposure.
- Like oxygen, ozone accelerates combustion. Keep the device away from heat sources, sparks and open flames.
- Use products only in the manner described in its User Guide. If any equipment is used in a manner not specified by the manufacturer, the safety protection provided by the equipment may be impaired.
- If the SoClean has been dropped or visibly damaged or if cracks in the tubing or enclosure are noticed, stop using the SoClean and contact SoClean.
- If you smell ozone and believe the SoClean device is not operating correctly, disconnect the power to the device and contact SoClean.



SoClean.com



0800 5558 8811

CLASSIFICATION, SYMBOLS, FCC NOTICE

Classification

US FDA Class I per 21 CFR § 880.6890 - General purpose disinfectants.

EC/EU MDD Class IIa per 93/42/EEC Annex IX Rule 15 - Specific disinfecting, cleaning and rinsing devices.

Symbols



Consult Manual



Complies with Medical Device
Directive of the European Union.



Serial Number



Catalogue number



Not made with
natural rubber latex

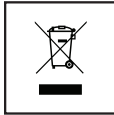

Waste Electrical & Electronic Equipment
(WEEE) It is the responsibility of the end
user to dispose of this equipment at a
designated collection point.



Manufacturer
JDI Electronics Factory
Sima Industrial Zone, Sima Village, Changping Town,
Dongguan City, Guangdong Province, China 523570



Date of Manufacture

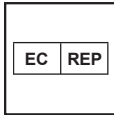

Authorised representative in
the European Community



FCC Notice

Please note that changes or modifications not expressly approved by the party responsible for compliance could void the user's authority to operate the equipment.

NOTE: This equipment has been tested and found to comply with the limits for a Class B digital device, pursuant to Part 18 of the FCC Rules. These limits are designed to provide reasonable protection against harmful interference in a residential installation. This equipment generates, uses and can radiate radio frequency energy and, if not installed and used in accordance with the instructions, may cause harmful interference to radio communications. However, there is no guarantee that interference will not occur in a particular installation. If this equipment does cause harmful interference to radio or television reception, which can be determined by turning the equipment off and on, the user is encouraged to try to correct the interference by one or more of the following measures:

- Reorient or relocate the receiving antenna.
- Increase the separation between the equipment and receiver.
- Connect equipment into an outlet on a circuit different from that to which the receiver is connected.
- Consult the dealer or an experienced radio/TV technician for help.

DISCLAIMER: SoClean is not responsible for any error, omission, misrepresentation or misstatement in these pages.